

Fitting Guide for Springsele® — single piece, double-acting static seal for high pressure equipment

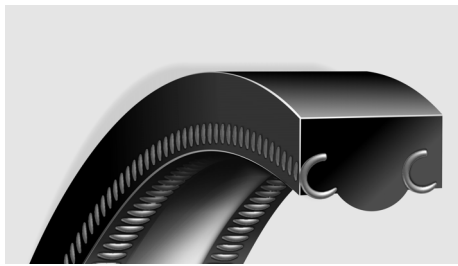

Springsele® internal seal

⚠ Please read these instructions fully before starting to fit the seal.

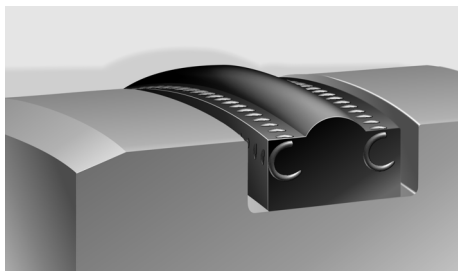

Springsele® external seal

1



Inspect the seal. Ensure that the Springsele® is the correct size and type for the housing and is in good condition.

Ⓞ Check seal type, size & condition

2



Clean the housing and inspect for sharp edges, burrs or any other areas that could damage the seal. Repair housing where necessary.

Ⓞ Clean the housing. Repair where necessary

A: Internal seal applications

A3

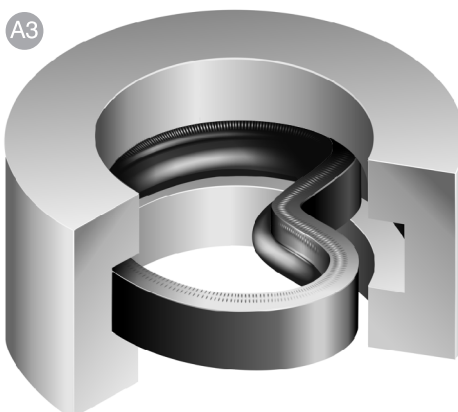

Insert the seal into the housing groove in the bore. If necessary, deform the seal into a crescent shape and position it into the groove.

Ensure that the seal is seated correctly with no twists, creases or kinks.

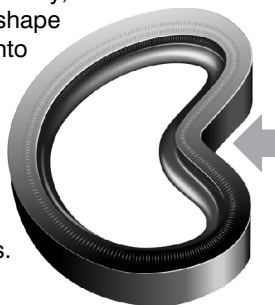

Ⓞ Fit seal into housing. Ensure it is seated correctly

Fitting Guide for Springsele® — single piece, double-acting static seal for high pressure equipment

A4

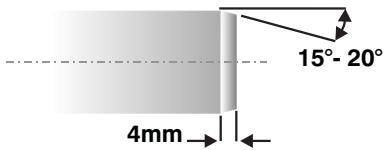

i Ensure that there is a 4mm minimum, 15°-20° lead-on at the end of the rod.

GB Align rod and firmly press through seal bore

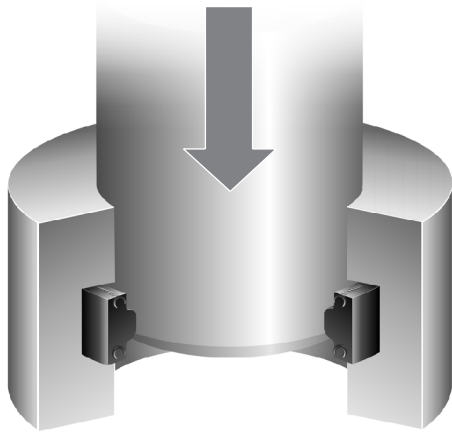

Align the rod carefully, and insert it until it just touches the seal, then press the rod firmly through the seal bore. The Springsele® is now installed.



A thin film of system compatible lubricant may be used (if in doubt, please contact James Walker or the equipment manufacturer).

B: External seal applications

B3

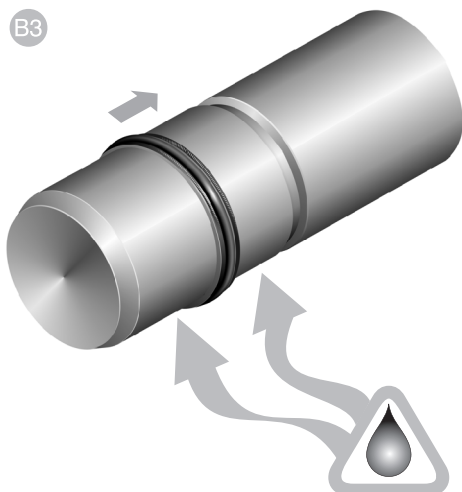

i Ensure that there is a 4mm minimum, 15°-20° lead-on at the end of the rod — refer to section B4 for fitting over abrasive surfaces.

GB Stretch seal on to rod and push to housing groove

Stretch the seal over the rod, using the lead-on to aid stretching. **Do not** stretch the ID of the seal to a diameter larger than its OD. Push the seal along the rod until it locates in the groove correctly.

Note: the seal may need time to recover and seat in the groove after being stretched.

A thin film of system compatible lubricant may be used (if in doubt, please contact James Walker or the equipment manufacturer).



100°C



30 mins

If the seal cannot be stretched sufficiently, then warm it for about 30 minutes at 100°C in a conventional oven. Once warmed, follow the fitting guide instructions shown above. Follow local Health & Safety regulations for handling of hot items.

Allow the seal to return to ambient temperature, then check that it is seated properly.

Fitting Guide for Springsele® — single piece, double-acting static seal for high pressure equipment

B4

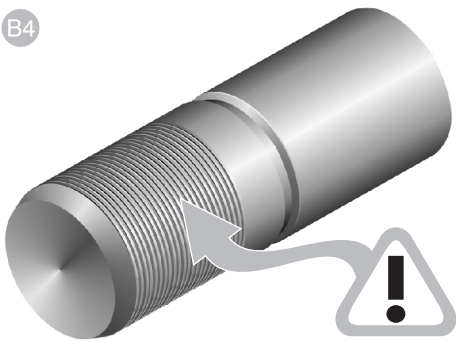

When the seal must pass over a threaded or abrasive surface, cover the rod surface to protect the seal. When passing over grooves, these should be filled to allow smooth transit of the seal.

ⓄB Cover threaded/abrasive areas before pushing seal over them

B5

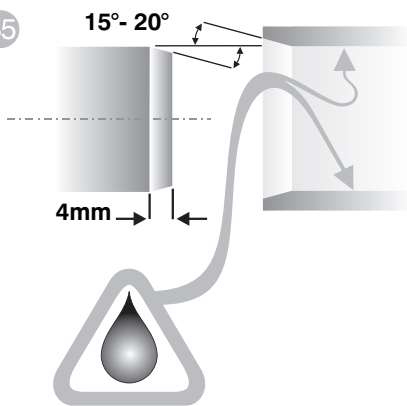

ⓘ Ensure that the bore has a 4mm minimum, 15°-20° lead-in.

Check that the Springsele® is seated correctly. Align the rod with the bore and firmly press the rod and seal in to position. The Springsele® is now installed.

ⓄB Ensure seal is seated correctly before inserting into the bore

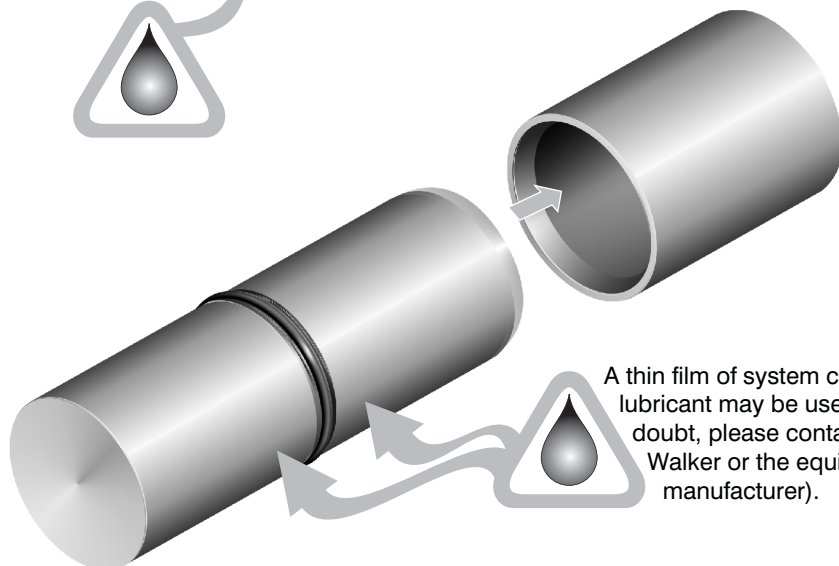

A thin film of system compatible lubricant may be used (if in doubt, please contact James Walker or the equipment manufacturer).

Material Safety Data Sheets are available on request

www.jameswalker.biz

James Walker & Co Ltd, Gote Brow, Cockermouth, Cumbria CA13 0NH, UK
Tel: +44 (0)1900 823555 Fax: +44 (0)1900 898354 Email: cockermouth@jameswalker.biz

Health warning: If fluoroelastomer (eg, FKM, FFKM, FEPDM) products are heated to elevated temperatures, fumes will be produced which may give unpleasant effects, if inhaled. Whilst some fumes are emitted below 250°C from fluoroelastomers, the effect at these temperatures is negligible. Care should be taken to avoid contaminating tobacco with particles of fluoroelastomer, which may remain on hands or clothing.

Information in this publication and otherwise supplied to users is based on our general experience and is given in good faith, but because of factors which are outside our knowledge and control and affect the use of products, no warranty is given or is to be implied with respect to such information. Unless governed by type approval or contract, specifications are subject to change without notice. Statements of operating limits quoted in this publication are not an indication that these values can be applied simultaneously.

To ensure you are working with the very latest product specifications, please consult the relevant section of the James Walker website: www.jameswalker.biz.

CPC: Springsele Level 05 AM05 PS05 12072013